

# 316 Stainless Steel Wafer type valves

## PRODUCT DATA – Standard specifications

Designed for mounting between Table “D” pipe flanges.

Sizes and	flow rate ranges avail.	standard no. of control rubbers
25mm	from 0.4 to 233 l/m	1
32mm	from 0.4 to 233 l/m	1
40mm	from 0.4 to 233 l/m	1
50mm	from 0.4 to 342 l/m	1 – 3
65mm	from 15 to 456 l/m	4
80mm	from 15 to 699 l/m	3
100mm	from 15 to 1279 l/m	6
150mm	from 25 to 2320 l/m	12
200mm	from 125 to 4427 l/m	19
250mm	from 25 to 6058 l/m	26
300mm	from 125 to 8854 l/m	38

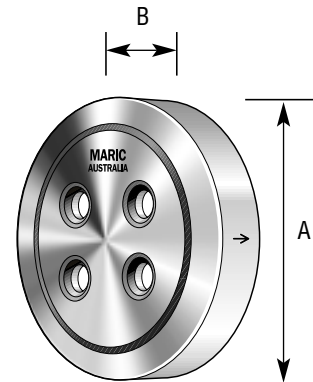

### Available flow rates litres/minute

.4 / .45 / .5 / .55 / .63 / .7 / .8 / .9 / 1.0 / 1.1 / 1.2 / 1.3 / 1.5 / 1.6 / 1.8 / 2.0 / 2.3 / 2.5 / 2.8 / 3.2 / 3.5 / 4.0 / 4.5 / 5.0 / 5.5 / 6.3 / 7.0 / 8.0 / 9.0 / 10 / 11 / 12 / 13 / 15 / 16 / 18 / 20 / 23 / 25 / 28 / 32 / 36 / 41 / 45 / 49 / 54 / 59 / 66 / 73 / 82 / 91 / 102 / 114 / 125 / 138 / 150 / 162 / 180 / 199 / 216 / 233 / up to 8854 l/m

**Pressure Differential Range** 140 – 1000 KPA } = Standard PRECISION Performance  
**Flow Rate Accuracy** +/- 10%

**Temperature Range** 0 – 60°C continuous

### Performance Graph Typical of all PRECISION valves irrespective of body size or flow rate

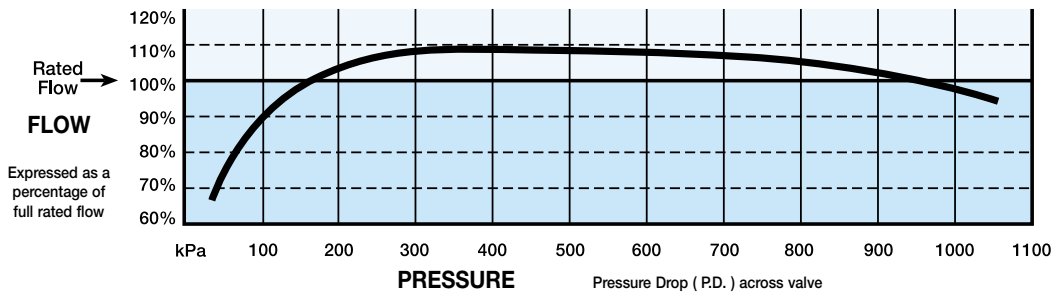

Materials	Body	316 stainless steel to ASTM A276/484
	Control rubber	Nitrile butadiene, potable water approved to AS4020
	O'Rings	Nitrile, potable water approved to AS4020

**Flange specification** Suits standard table “D” flanges to AS2129  
 Standard Wafers are not full flange type i.e. flange bolts locate wafer concentrically and remain visible when viewing assembly.

### Wafer Dimensions

Nominal size	25	32	40	50	65	80	100	150	200	250	300
Diameter “A”	71.0	75.0	86.0	98.0	111.0	130.0	162.0	219.0	276.0	336.0	386.0
Thickness “B” Stainless Steel	22.0	22.0	22.0	22.0	22.0	22.0	24.0	24.0	28.0	32.0	40.0

**Non-Standard Specifications** - Alternative flange specifications, Higher flow rates, Kwiflo (quiet) valves, EPDM or Viton control rubbers, Higher or lower pressure ranges, may be available in certain valve configurations. Refer to Non-Standard Specification Availability data for options

www.maric.com.au

Telephone:

08 8431 2281

(Int'l 61 8 8431 2281)

Facsimile:

08 8431 2025

